

VIZ-ART CINE-LIFT



Advantages of the lift: Housing cover the projector on three sides. Unique design and stylish look, made with attention to every detail. Suitable every home cinema setup. Appreciated by designers and demanding users. Quick installation (click system).

Functionality: lift cover hides the projector; accurate positioning; precise settings; quiet operation; Somfy drive; control options: IR and RF remote control, Trigger, RS232, LVC, SMART Box.



70cm



Newest ceiling mounted projector lift design. Ideal for use in the most elegant home theatre interiors. The interesting lift casing allows for

extremely easy installation, while the projector is protected and only slightly visible.

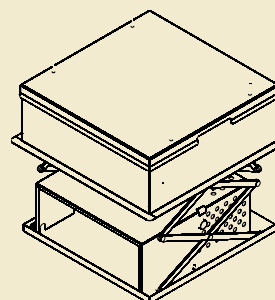
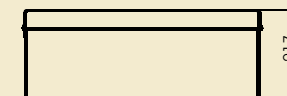
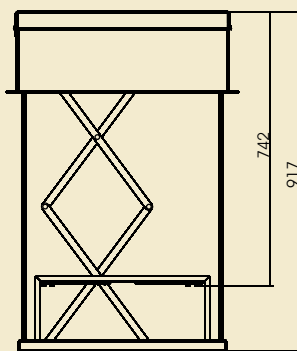
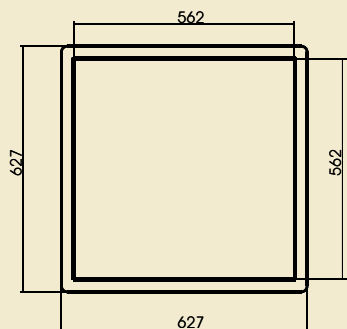
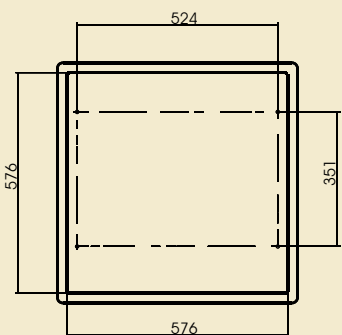

Available models: • CINE-LIFT 8/700



CINE-LIFT	
Extension [mm]	700
Capacity [kg]	8
Own weight [kg]	27
Dimensions [mm]	D 627; W 627
Installation space [mm]	217
Max dimensions of projector [mm]	W - 445 D - 470 H - 160
Mounting hole in the ceiling[mm]	590x590
Remote control	• wall switch • option: IR, RF, Trigger, RS232, LVC, SMART Box
Power supply	SOMFY, 220V-60Hz, 230V-50Hz; 90W; 42dB
Security	• thermal and overload protection,
Set	• lift; • assembly kit; • wall switch; • mounting instruction manual;
Warranty	2 years (power supply)
Producer	VIZ-ART Automation Europe