

SMARTBOARD LIFT

Advantages of the lift: easy set-up and remote or button control; for set-up on the wall and mobile stand use.

Functionality: fast adjustment of SMARTBOARD height for Users of different heights; connection without programming.

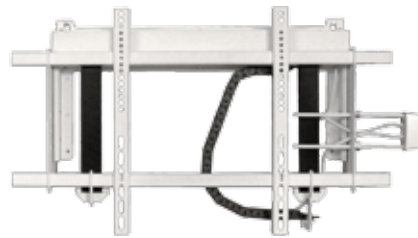
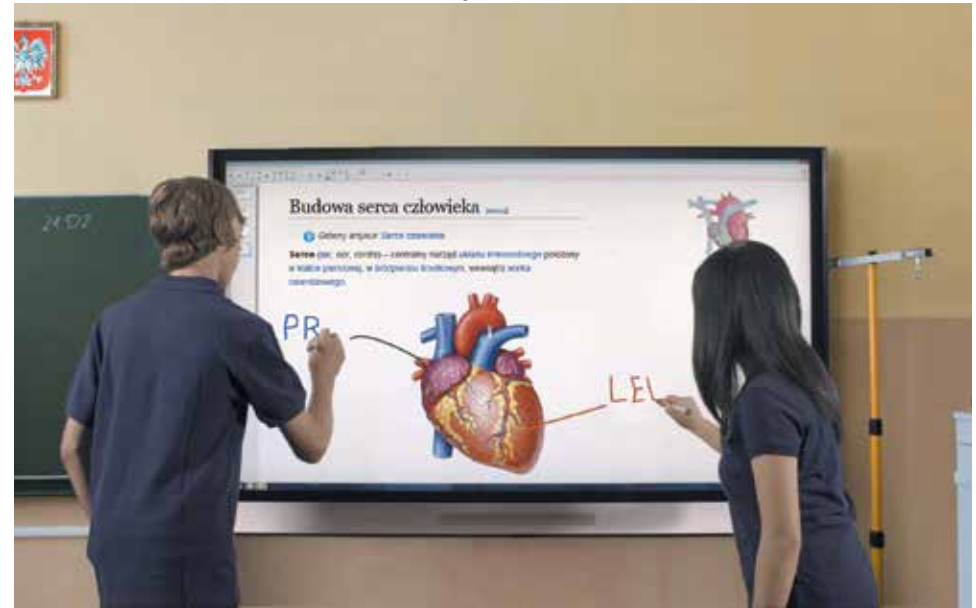
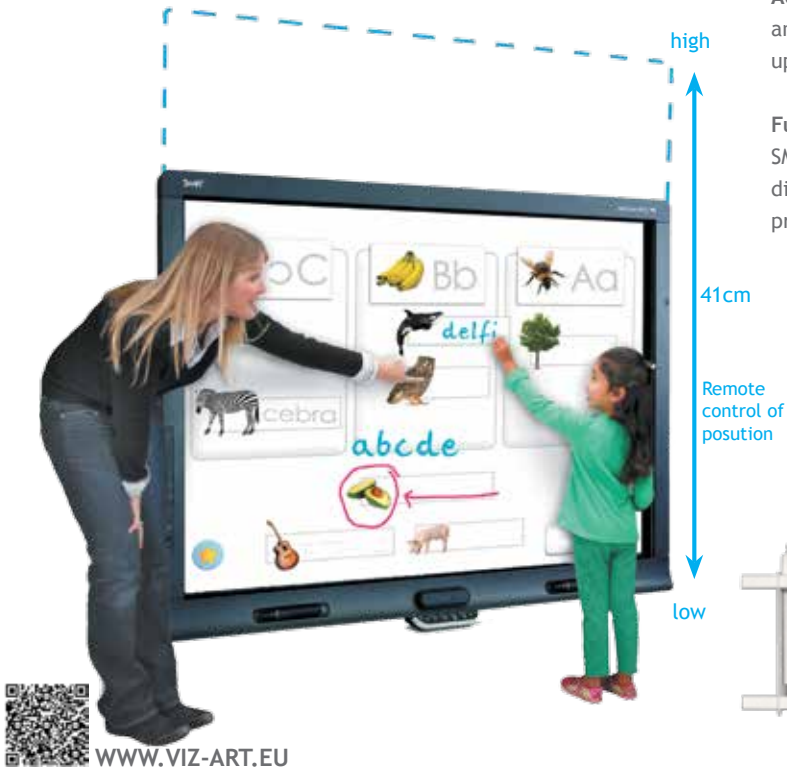

Electric lift for interactive SMARTBOARDS, plasma and LCD TV sets. Dedicated to set up on the wall, and mobile stands.

Easy monitor height adjustment for the convenience of different Users.

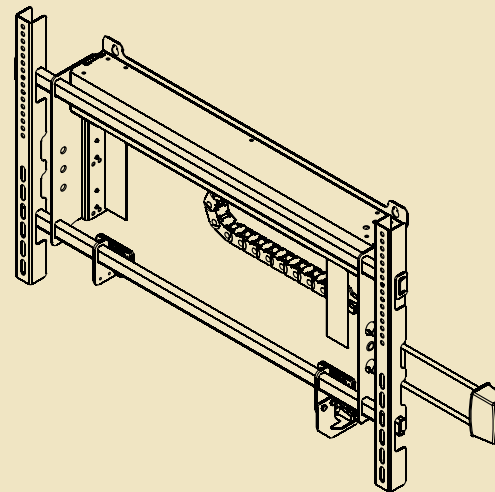
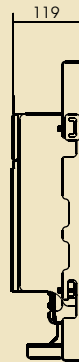
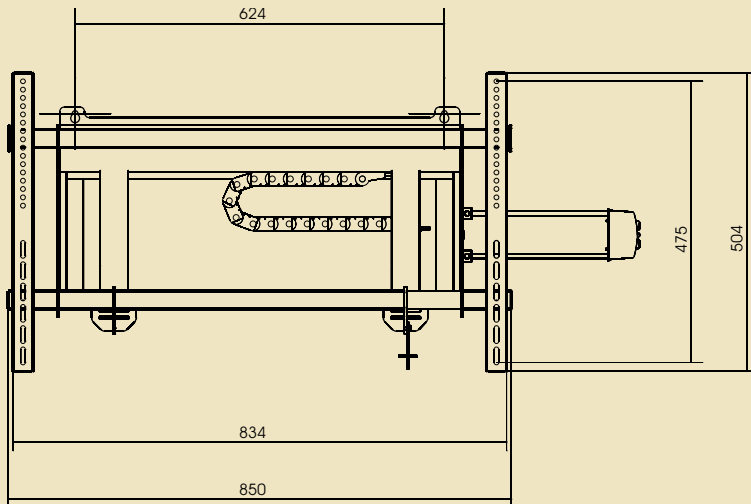

SMARTBOARD LIFT

Extension [mm]	to 90"
Capacity [kg]	70
Own weight [kg]	16,5
Extension [mm]	410
Installation	<ul style="list-style-type: none"> • wall • stand
Remote control	<ul style="list-style-type: none"> • switch key • option: IR, RF, Trigger, RS232
Producer	VIZ-ART Automation Europe

