

ELLIPSE TENSION



Advantages of the screen:
a tensioned screen projection surface and the casing design are the most important attributes of a good screen.

Functionality: tensioned screen projection surface; every aspect ratio; stylish aluminium casing; full customization; Somfy drive with 5 years warranty; upper top BB; control options: IR, RF remote control, Trigger, RS232.



High-class projection screens with projection surface tensioners and original satin elliptical casing. The TENSION system tensions the projection surface of the screen in order to ensure that projection is comfortable. This line of screens has been created in response to the high expectations of demanding customers completing their dream Home Theatre.

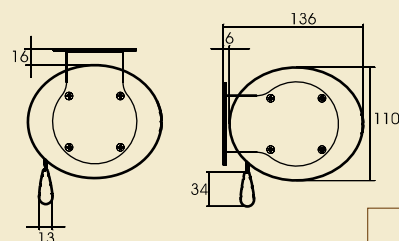
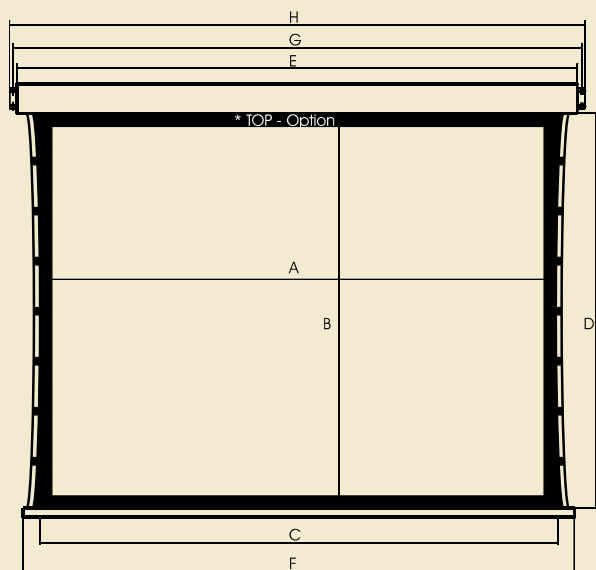

$$\begin{aligned}
 C &= A + 100 \\
 D &= B + 100 \\
 E &= A + 319 \\
 F &= A + 280 \\
 G &= A + 351 \\
 H &= A + 375
 \end{aligned}$$

	Width (cm)		Size (mm)			
			4:3		16:9	
	A	B	A	B	A	B
ELLIPSE TENSION 184	1740	1310	1740	980	1740	1090
ELLIPSE TENSION 204	1940	1460	1940	1090	1940	1220
ELLIPSE TENSION 264	2540	1910	2540	1430	2540	1590
ELLIPSE TENSION 284	2740	2060	2740	1540	2740	1720
ELLIPSE TENSION 304	2940	2210	2940	1660	2940	1840
ELLIPSE TENSION 334	3240	2430	3240	1830	3240	2030
ELLIPSE TENSION 364	3540	2660	3540	1990	3540	2220
ELLIPSE TENSION 384	3740	2810	3740	2110	3740	2340

Screen ELLIPSE TENSION

Casing	aluminium, silver, elliptical shape,
Case profile	ellipse (W 13 cm x H 11 cm)
Installation	• ceiling; • wall
P. surfaces:	• Matt White • Cine Grey • 1,0G • 500g • 150° • 0,5mm • 0,8G • 490g • 170° • 0,5mm
Image aspect ratio	• 4:3 • 16:9 • 16:10 • and more
Max. Width of base [cm]	550
Control system	• wall switch • option: IR RF, Trigger 5-30V, Trigger 230V, RS232
Back of projection surface	black, white
Power supply	SOMFY, 230V 50Hz; 42dB
Options	• „B” - Background • „BB” - top black belt • case colours RAL
„B” Background Frame	width - 5cm
Set	• screen; • mounting instruction manual; • wall switch; • assembly kit;
Warranty	5 years (power supply)
Producer	VIZ-ART Automation Europe

